

序号	品名	材质
①	0.5拉拔三代胶芯 (H2.0)	LCP UL94V-0 本色
②	0.5拉拔三代下端子 (H2.0)	磷青铜/表面镀锡
③	0.5拉拔三代后盖 (H2.0)	LCP UL94V-0 黑色
④	0.5拉拔三代焊片 (H2.0)	黄铜/表面镀锡

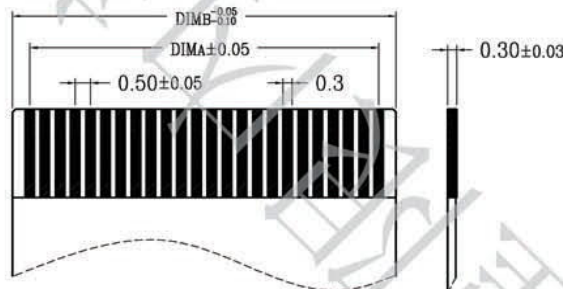
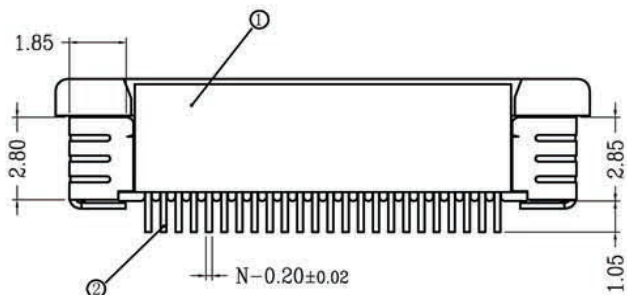
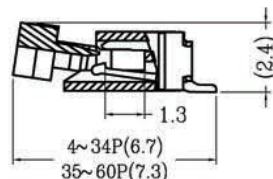
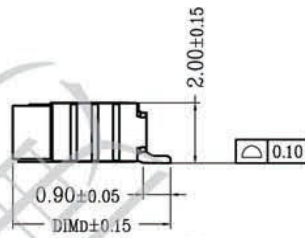
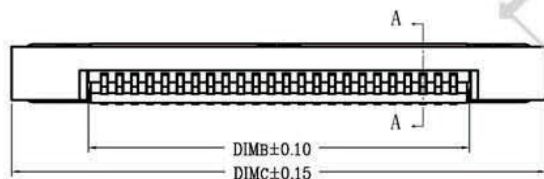
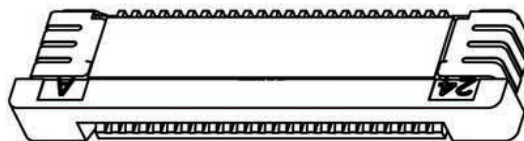
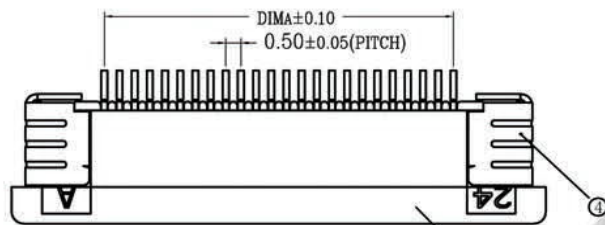

SECTION A-A

CKT	DIM A	DIM B	DIM C	DIM D	CKT	DIM A	DIM B	DIM C	DIM D
4	1.50	2.56	7.60	5.20	33	16.00	17.06	22.10	5.20
5	2.00	3.06	8.10		34	16.50	17.56	22.60	
6	2.50	3.56	8.60		35	17.00	18.06	23.10	
7	3.00	4.06	9.10		36	17.50	18.56	23.60	
8	3.50	4.56	9.60		37	18.00	19.06	24.10	
9	4.00	5.06	10.10		38	18.50	19.56	24.60	
10	4.50	5.56	10.60		39	19.00	20.06	25.10	
11	5.00	6.06	11.10		40	19.50	20.56	25.60	
12	5.50	6.56	11.60		41	20.00	21.06	26.10	
13	6.00	7.06	12.10		42	20.50	21.56	26.60	
14	6.50	7.56	12.60		43	21.00	22.06	27.10	
15	7.00	8.06	13.10	44	21.50	22.56	27.60		
16	7.50	8.56	13.60	45	22.00	23.06	28.10		
17	8.00	9.06	14.10	46	22.50	23.56	28.60		
18	8.50	9.56	14.60	47	23.00	24.06	29.10		
19	9.00	10.06	15.10	48	23.50	24.56	29.60		
20	9.50	10.56	15.60	49	24.00	25.06	30.10		
21	10.00	11.06	16.10	50	24.50	25.56	30.60		
22	10.50	11.56	16.60	51	25.00	26.06	31.10		
23	11.00	12.06	17.10	52	25.50	26.56	31.60		
24	11.50	12.56	17.60	53	26.00	27.06	32.10		
25	12.00	13.06	18.10	54	26.50	27.56	32.60		
26	12.50	13.56	18.60	55	27.00	28.06	33.10		
27	13.00	14.06	19.10	56	27.50	28.56	33.60		
28	13.50	14.56	19.60	57	28.00	29.06	34.10		
29	14.00	15.06	20.10	58	28.50	29.56	34.60		
30	14.50	15.56	20.60	59	29.00	30.06	35.10		
31	15.00	16.06	21.10	60	29.50	30.56	35.60		
32	15.50	16.56	21.60						

适用线路板

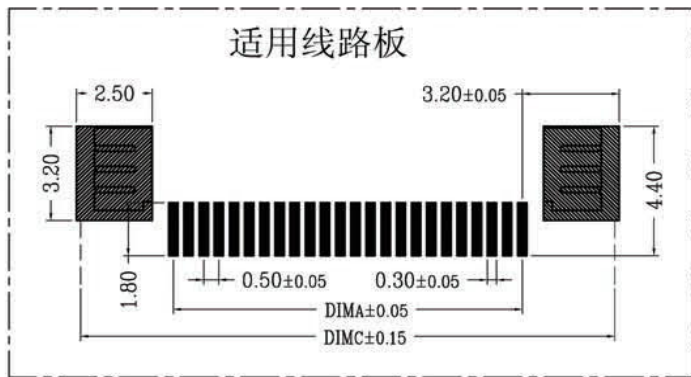

适用扁平线

技术指标:

1. 塑件表面应光洁、无毛边、无明显收缩、缺陷、裂纹等现象。
2. 温度范围: -25° C~85° C.
3. 额定电压: 50V, AC/DC(等效).
4. 接触电阻: ≤0.03Ω.
5. 绝缘电阻: ≥500MΩ

一般公差 (TOLERANCE)  
 X ±0.10 XX ±0.15  
 Y ±0.20 XXX ±0.05  
 ANGLES ±1°

深圳市中航标电子有限公司		WWW.BDS666.COM	
KH-CL0.5-H2.0-16PIN		0755-83044319	
品名 (TITLE)	0.5 Pitch拉拔三代卧式下接 (H=2.0)	制图 (DR)	王涛
料号 (DWG.NO)	2046-XXXX	校对 (CHKD)	吴鹏
比例 (SCALE)	1:1	审核 (APPD)	黄志明
单位 (UNITS)	mm	张数 (SHEET)	1 OF 1
		SIZE	A4
		REV	1