

PCB LAYOUT  
S=2:1

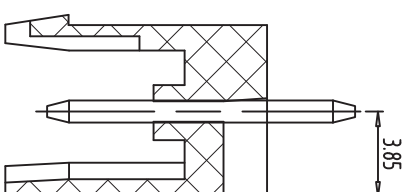

SECTION:A-A

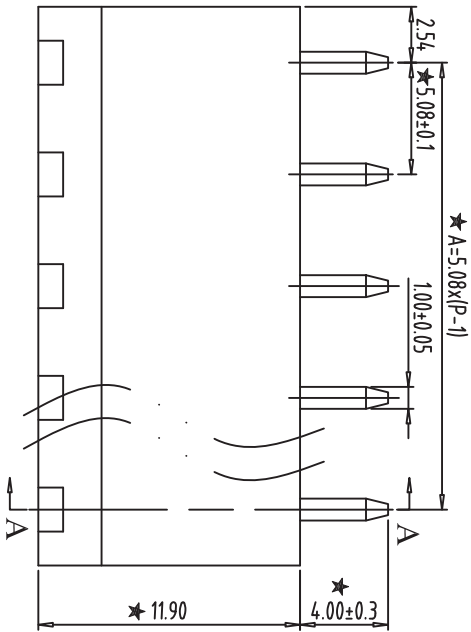
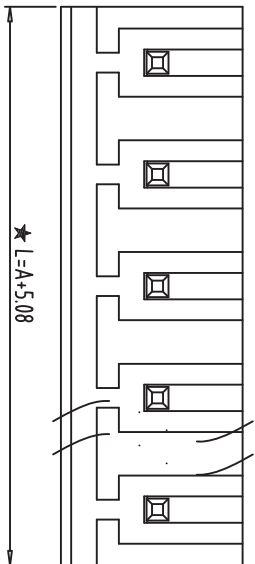
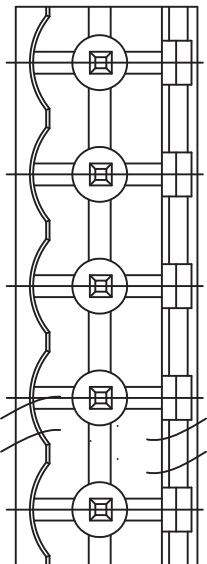
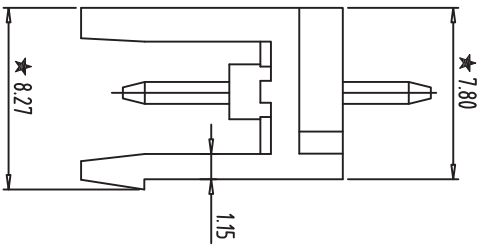

- NOTES:
1. Rating:300V 15A ;
  2. Insulation Withstands Voltage: AC2000V/MIN
  3. Insulation Resistance: 500M $\Omega$  or more at DC500V
  4. Using Temperature Range: -40°C~+105°C
  5. “ $\star$ ” is the important dimension
  6. RoHS compliance

Total Pitch Tolerances		Nominal dimension range																												
In mm		In mm																												
0	to	0	to	30	to	53	to	70	to	90	to	115	to	150	to	200	to	250	to	320	to	400	to	500	to	630	to	800	to	1000
$\pm 0.18$	to	$\pm 0.20$	to	$\pm 0.25$	to	$\pm 0.3$	to	$\pm 0.35$	to	$\pm 0.4$	to	$\pm 0.44$	to	$\pm 0.5$	to	$\pm 0.55$	to	$\pm 0.6$	to	$\pm 0.7$	to	$\pm 0.8$	to	$\pm 0.9$	to	$\pm 1.0$	to	$\pm 1.2$	to	$\pm 1.5$
0	to	30	to	53	to	70	to	90	to	115	to	150	to	200	to	250	to	320	to	400	to	500	to	630	to	800	to	1000	to	1250
$\pm 0.18$	to	$\pm 0.20$	to	$\pm 0.25$	to	$\pm 0.3$	to	$\pm 0.35$	to	$\pm 0.4$	to	$\pm 0.44$	to	$\pm 0.5$	to	$\pm 0.55$	to	$\pm 0.6$	to	$\pm 0.7$	to	$\pm 0.8$	to	$\pm 0.9$	to	$\pm 1.0$	to	$\pm 1.2$	to	$\pm 1.5$

REV	CONTENT	CHK	DATE
V0.0	CONTENT	SK	2014/08/19

ITEM	NAME OF PART	NO. OF PART	Q'TY	MATERIAL	NOTE
DWG	SK	DATE 2014/08/19	SIZE A4	UNITS mm	SHEET/OF 1/1
CHK	DATE		SCALE 3:1		2EDG-5.08
APP.	DATE		NAME		

深圳市金航标电子有限公司  
KH-F400V-5P-5.08G  
WWW.BDS666.COM  
0755-83044319