

Kinghelm®

REV	ECN NO	DESCRIPTION	DATE	APPD
A		*****	2014.03.11	

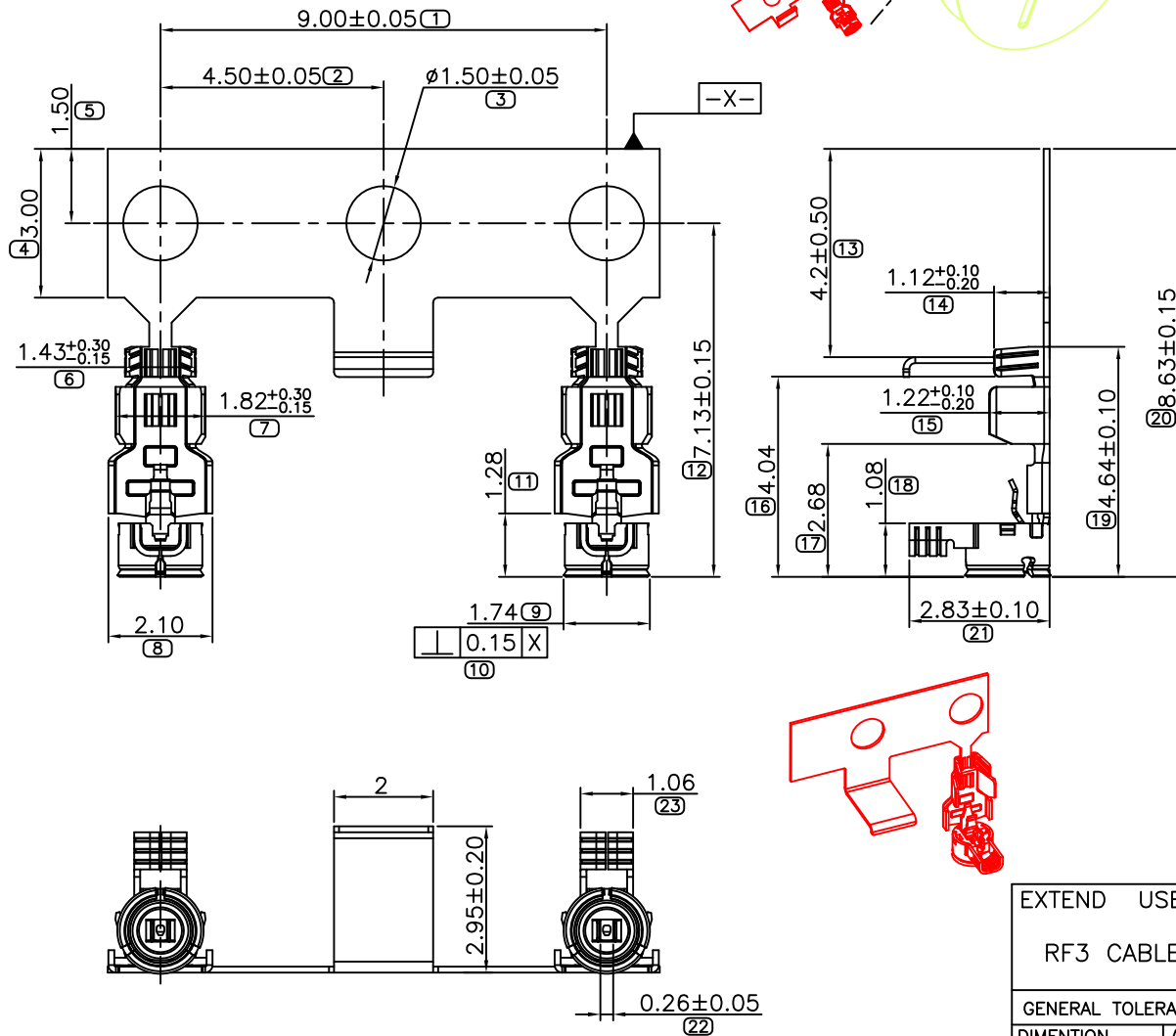

说明:  
NOTE:

1. 塑胶材料: 热塑性塑胶;  
HOUSING MATERIAL: THERMOPLASTIC PLASTIC, UL 94V-0;  
端子材料: 铜合金, 表面镀金;  
CONTACT MATERIAL: COPPER ALLOY, GOLD PLATED ALL OVER;  
外壳材料: 铜合金, 表面镀金或镀镍;  
SHELL MATERIAL: COPPER ALLOY, GOLD OR NICKEL PLATED ALL OVER;

2. 产品性能:  
PERFORMANCE:
  - 2.1. 接触阻抗: 20mΩ Max.  
CONTACT RESISTANCE: 20mOHM Max.
  - 2.2. 耐电压: 200V AC, 1 Minute;  
DIELECTRIC WITHSTANDING VOLTAGE: 200V AC FOR 1MINUTE;
  - 2.3. 绝缘阻抗: 500MΩ Min.  
INSULATION RESISTANCE: 500MOHM Min.
  - 2.4. 插拔耐久性: 30次 Min.  
DURABILITY: 30TIMES Min.

EXTEND USE			TITLE		深圳市金航标电子有限公司 SHENZHEN KINGHELM ELECTRON CO.,LTD.		
RF3 CABLE CONN			UNIT	RF3 CABLE CONN CUSTOMER DRAWING			
GENERAL TOLERANCE (M)		MATERIAL	APPD		DWG NO KH-IPEX3-0.81		
DIMENTION	ANGLES	QTY	CHD		P/N: (见说明)		
0. ±0.30	0. ±3.0°	FINISHED	DRN *****		SHEET	SCALE	REV
.0 ±0.20	.0 ±2.0°		2014.03.11		1/2	1:1	A
.00 ±0.10	.00 ±1.0°						
.000 ±0.05							

**Kinghelm®**

REV	ECN NO	DESCRIPTION	DATE	APPD
		SEE SHEET 1/3		

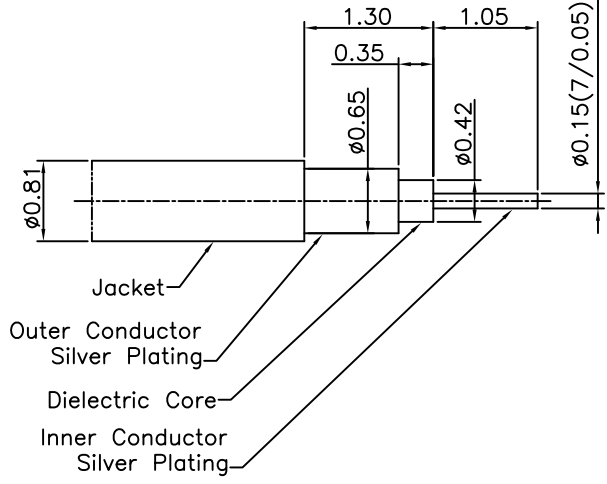
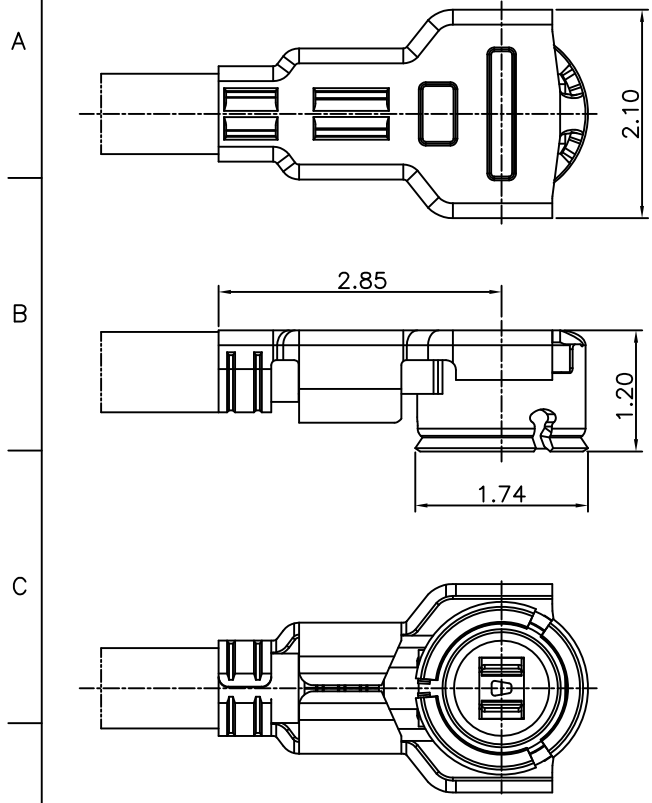

Applicable cable nominal dimension(OD0.81 RF Connector)

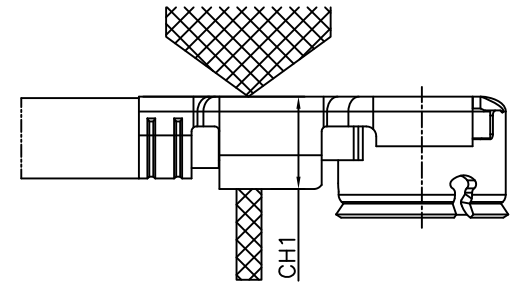

CH1: 0.83~0.86

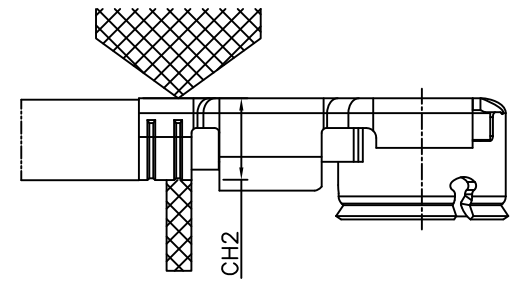

CH2: 0.77~0.80(Ref.)

为保证产品引张强度针对不同线材  
CH2尺寸需作调整

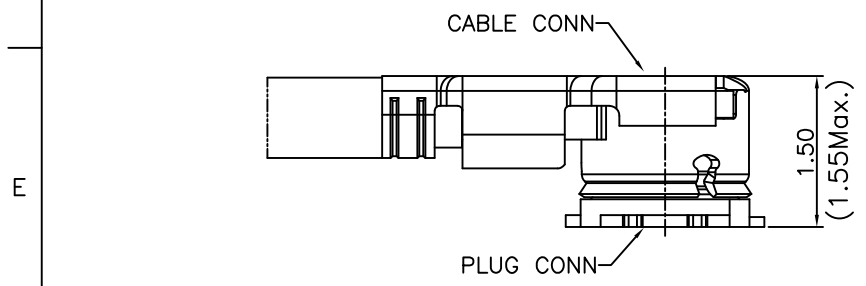

SCALE: 2:1

EXTEND USE		UNIT	TITLE	
RF3 CABLE CONN			mm	RF3 CABLE CONN CUSTOMER DRAWING
GENERAL TOLERANCE (M)		MATERIAL	APPD	深圳市金航标电子有限公司 SHENZHEN KINGHELM ELECTRON CO.,LTD.
DIMENTION	ANGLES	QTY	CHD	DWG NO KH-IPEX3-0.81
0. ±0.30	0. ±3.0°	FINISHED	DRN *****	P/N: (见说明)
.0 ±0.20	.0 ±2.0°			SHEET 2/2
.00 ±0.10	.00 ±1.0°			SCALE 1:1
.000 ±0.05				REV A

2014.03.11