

SPECIFICATIONS

- 1、Current Rating: 3A AC, DC
- 2、Voltage Rating: 100V AC, DC
- 3、Temperatuer Range: $-25^{\circ}\text{C} \sim +85^{\circ}\text{C}$
- 4、Contact Resistance: $20\text{m}\Omega$ Max
- 5、Insulation Resistance: $1000\text{M}\Omega$ Min
- 6、Withstanding Voltang: 800V AC/minute
- 7、Material: Wafer PBT, UL94V-0
PIN Brass Tin-plated

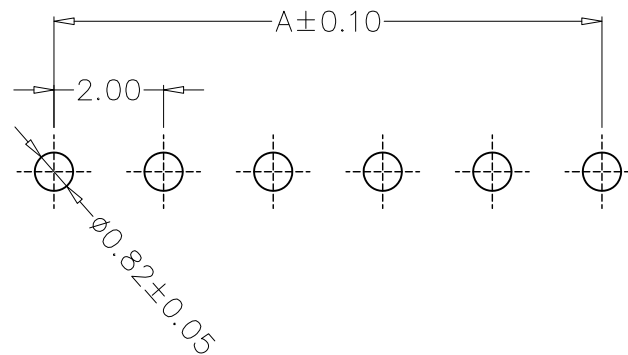

PCB LAYOUT

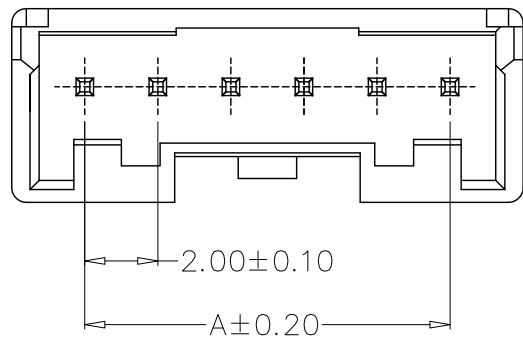
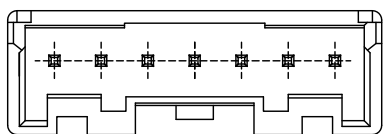

7~9A

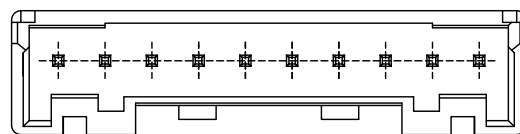

10~16A

编 号	尺寸 (mm)	
	A	B
A2026-02A	2.00	6.00
A2026-03A	4.00	8.00
A2026-04A	6.00	10.00
A2026-05A	8.00	12.00
A2026-06A	10.00	14.00
A2026-07A	12.00	16.00
A2026-08A	14.00	18.00
A2026-09A	16.00	20.00
A2026-10A	18.00	22.00
A2026-11A	20.00	24.00
A2026-12A	22.00	26.00
A2026-16A	30.00	34.00

GENERAL TOLERANCE		制图	钱岳生		料号	A2026-NA		版本	A
X.±0.25	X.*±2'	DRAWING	2021、05、03		PART NO.	PA直针		REV.	1/1
.X±0.20	.X'±1'	审核	张名		TITLE	WAFER DIP TYPE		SHEET	1/1
.XX±0.15	.XX'±0.5'	核 准	张名		客户料号	深圳市金航标电子有限公司		www.kinghelm.com.cn	
.XXX±0.10	.XXX'±0.5'	APPROVAL	2021、05、05		CUTM. NO.	KH-A2026-06A		0755-28190160	
UNIT	MM	SCALE	1:1						