

# Kinghelm®

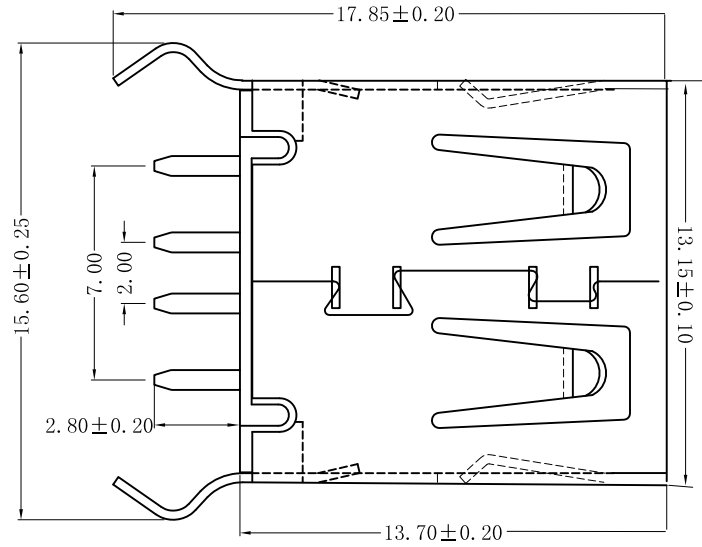
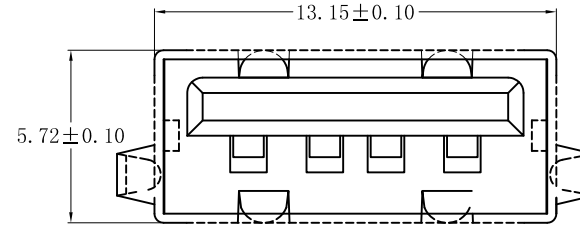
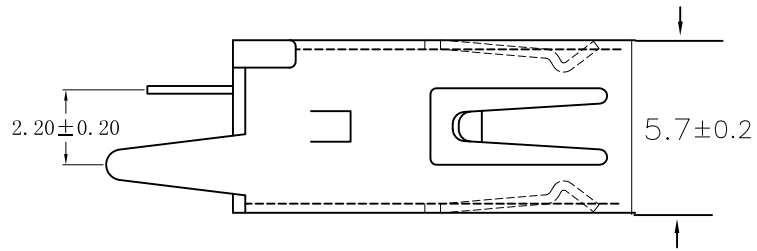

规格说明: Specifications:

电气特性: Electrical:

1. 额定电流: Current Rating  
1.5A/contact terminal
2. 额定电压: Voltage Rating  
30V DC
3. 接触阻抗: Contact Resistance  
30 milliohms MAX
4. 耐电压: Dielectric Withstanding Voltage:  
500 V AC AT Sea Level
5. 绝缘阻抗: Insulation Resistance:  
1000MEGA ohms MIN

原材料: Material:

1. 塑胶: Housing:  
High Temperature Thermoplastics,  
PBT/LCP White/Black
2. 端子: Contact: Copper Alloy C2680
3. 外壳: Shell: Copper Alloy C2680/SPCC

电镀: Finish:

1. 端子: Contact: Plated Gold in Mating Area;  
Tin On Solder Tails
2. 外壳: Shell:  
Nickel Plating

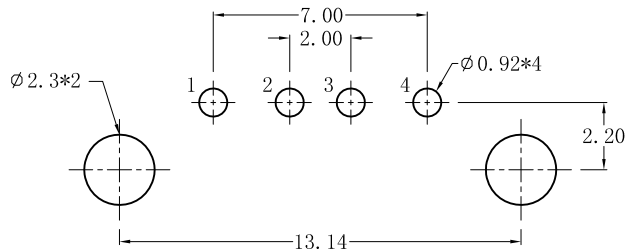

深圳市金航标电子有限公司		WWW.BDS666.COM	图号 (DWG NO)	单位 (UNIT): MM
KH-AF180WJ-13.7		0755-83044319	版本 (REV)	A/1
品名 (ITEM NO)			日期 (DATE)	
料号 (PART NO)			设计 (DESIGN)	未注公差 TOLERANCE UNSPECIFIED
模号 (MODEL NO)	UB001G		审核 (CHECKED)	X.X ±0.30
			核准 (APPROVED)	X.XX ±0.20
				X.XXX ±0.10
				X° ±5°
				X.X° ±2°